

Sliding door system | ECO RG-391

Max door weight 60 Kg



Determination Of Door Size

MIN. Glass Door Width=750mm

MAX. Height-Width Ratio of The Door is 2.5: 1

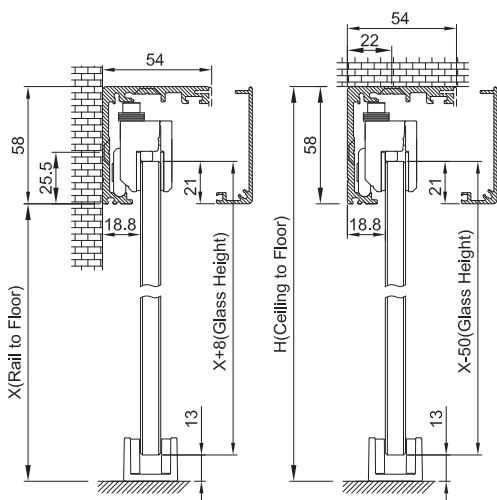
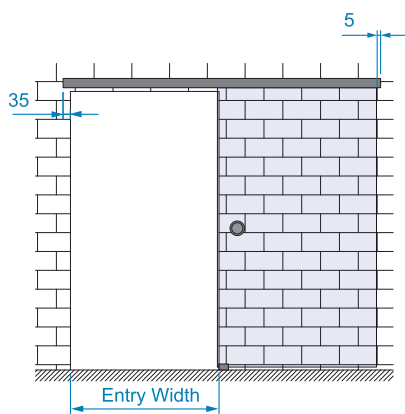
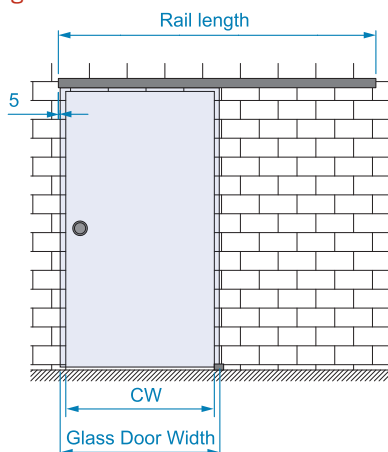

Standard Rail Length 2000mm

CW MAX. = 950mm

(Option Rail Length 2400mm,
CW MAX. = 1150mm)

CW = Clear opening width

Glass Door Width = CW+60 Rail

Length = (2 X CW)+100

Entry Width = CW



1. Side Panel Top Rail(Optional)

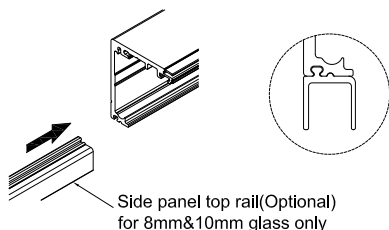

2. Wall/Ceiling/Glass Mounting

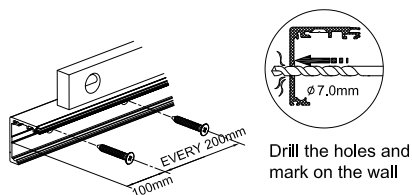

2-1. End Bracket Mounting

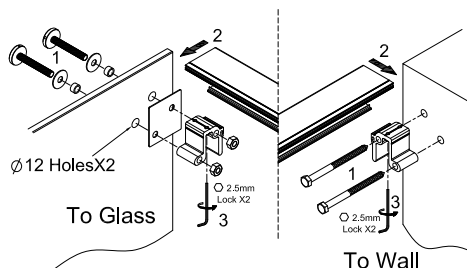

3. Clean The Track After Mounting

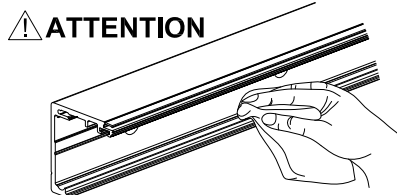

4. Bottom Guide

Glass Thickness	A(mm)
12mm	24.8
10mm	23.8
8mm	22.8

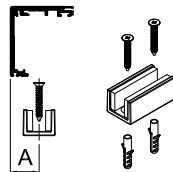

5. Side Panel(Optional)

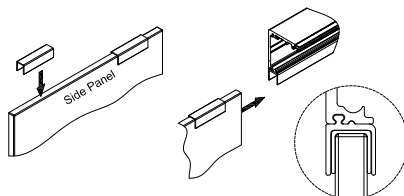

6. Standard for 8mm&10mm

Glass Door

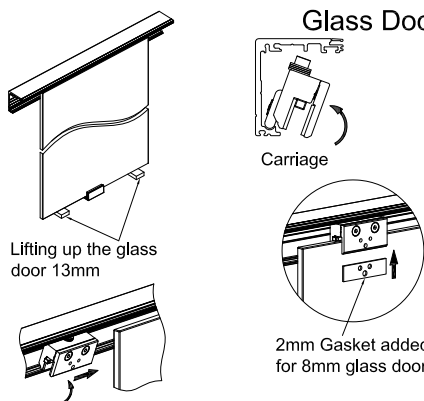

7.

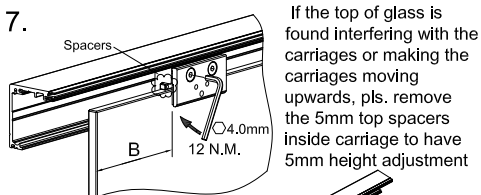

	B(mm)
Stopper	80
Soft Closing	190

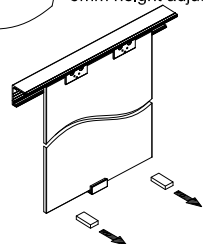

8. Stopper

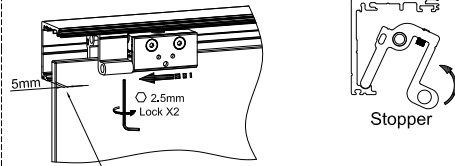

Please keep the glass about
5mm space from the end of rail

